



The Best Products, The Best Service...

# SERVICE METAL

ONE CALL GETS IT ALL

## Lap Joint Flange CLASS 1500 Inches / Pounds

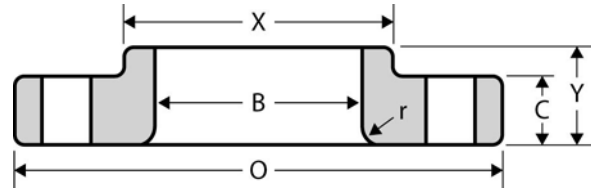

Nominal Pipe Size	Outside Diam. of Flange (O)	Thick. of Flange (C)	Diam. of Hub at Base (X)	Length thru Hub (Y)	Diam. of Bore (B)	Fillet Radius (r)	No. of Holes	Diam. of Holes	Diam. of Bolts	Diam. of Bolt Circle	Approx. Weight (in Pounds)
1/2	4.75	0.88	1.50	1.25	0.90	0.12	4	0.88	0.75	3.25	4
3/4	5.12	1.00	1.75	1.38	1.11	0.12	4	0.88	0.75	3.50	5
1	5.88	1.12	2.06	1.62	1.38	0.12	4	1.00	0.88	4.00	8
1 1/4	6.25	1.12	2.50	1.62	1.72	0.19	4	1.00	0.88	4.38	9
1 1/2	7.00	1.25	2.75	1.75	1.97	0.25	4	1.12	1.00	4.88	12
2	8.50	1.50	4.12	2.25	2.46	0.31	8	1.00	0.88	6.50	25
2 1/2	9.62	1.62	4.88	2.50	2.97	0.31	8	1.12	1.00	7.50	35
3	10.50	1.88	5.25	2.88	3.60	0.38	8	1.25	1.12	8.00	47
4	12.25	2.12	6.38	3.56	4.60	0.44	8	1.38	1.25	9.50	75
5	14.75	2.88	7.75	4.12	5.69	0.44	8	1.62	1.50	11.50	140
6	15.50	3.25	9.00	4.69	6.75	0.50	12	1.50	1.38	12.50	170
8	19.00	3.62	11.50	5.62	8.75	0.50	12	1.75	1.62	15.50	285
10	23.00	4.25	14.50	7.00	10.92	0.50	12	2.00	1.88	19.00	485
12	26.50	4.88	17.75	8.62	12.92	0.50	16	2.12	2.00	22.50	630
14	29.50	5.25	19.50	9.50	14.18	0.50	16	2.38	2.25	25.00	890
16	32.50	5.75	21.75	10.25	16.19	0.50	16	2.62	2.50	27.75	1,050
18	36.00	6.38	23.50	10.88	18.20	0.50	16	2.88	2.75	30.50	1,475
20	38.75	7.00	25.25	11.50	20.25	0.50	16	3.12	3.00	32.75	1,775
24	46.00	8.00	30.00	13.00	24.25	0.50	16	3.62	3.50	39.00	2,825

\* Dimensions conform to ASTM A/SA-105; ANSI B16.5