

The Best Products, The Best Service...

SERVICE METAL

ONE CALL GETS IT ALL



Socket Weld Lateral 3000# Forged Steel Inches / Pounds

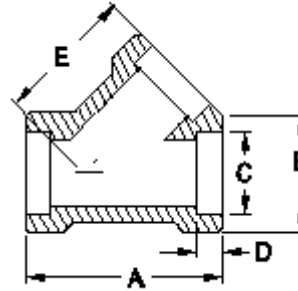

Size	A	B	C	D	E	Approximate Weight (in Pounds)
1/8	2.50	1.50	.426	.41	1.75	1.25
1/4	2.50	1.50	.560	.41	1.75	1.21
3/8	2.50	1.50	.693	.41	1.75	1.09
1/2	2.50	1.50	.859	.41	1.75	.94
3/4	3.00	1.75	1.071	.53	2.13	1.47
1	3.50	2.00	1.335	.53	2.50	2.23
1 1/4	4.00	2.44	1.682	.53	2.81	3.31
1 1/2	4.50	2.75	1.922	.53	3.02	4.89
2	6.00	3.31	2.410	.66	4.38	9.68
2 1/2	7.50	4.00	2.910	.66	5.31	18.33

**ASTM SA-105, ANSI B16.11*