



The Best Products, The Best Service...

# SERVICE METAL

ONE CALL GETS IT ALL

## Lap Joint Flange CLASS 300 Inches / Pounds

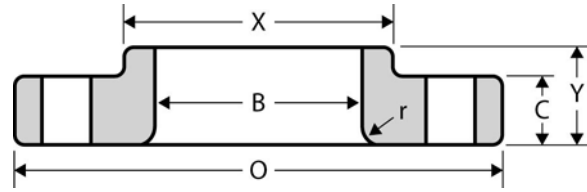

Nominal Pipe Size	Outside Diam. of Flange (O)	Thick. of Flange (C)	Diam. of Hub at Base (X)	Length thru Hub (Y)	Diam. of Bore (B)	Fillet Radius (r)	No. of Holes	Diam. of Holes	Diam. of Bolts	Diam. of Bolt Circle	Approx. Weight (in Pounds)
1/2	3.75	0.56	1.50	0.88	0.90	0.12	4	0.62	0.50	2.62	2
3/4	4.62	0.62	1.88	1.00	1.11	0.12	4	0.75	0.62	3.25	3
1	4.88	0.69	2.12	1.06	1.38	0.12	4	0.75	0.62	3.50	3
1 1/4	5.25	0.75	2.50	1.06	1.72	0.19	4	0.75	0.62	3.88	4
1 1/2	6.12	0.81	2.75	1.19	1.97	0.25	4	0.88	0.75	4.50	6
2	6.50	0.88	3.31	1.31	2.46	0.31	8	0.75	0.62	5.00	7
2 1/2	7.50	1.00	3.94	1.50	2.97	0.31	8	0.88	0.75	5.88	10
3	8.25	1.12	4.62	1.69	3.60	0.38	8	0.88	0.75	6.62	13
3 1/2	9.00	1.19	5.25	1.75	4.10	0.38	8	0.88	0.75	7.25	17
4	10.00	1.25	5.75	1.88	4.60	0.44	8	0.88	0.75	7.88	22
5	11.00	1.38	7.00	2.00	5.69	0.44	8	0.88	0.75	9.25	28
6	12.50	1.44	8.12	2.06	6.75	0.50	12	0.88	0.75	10.62	39
8	15.00	1.62	10.25	2.44	8.75	0.50	12	1.00	0.88	13.00	58
10	17.50	1.88	12.62	3.75	10.92	0.50	16	1.12	1.00	15.25	91
12	20.50	2.00	14.75	4.00	12.92	0.50	16	1.25	1.12	17.75	140
14	23.00	2.12	16.75	4.38	14.18	0.50	20	1.25	1.12	20.25	190
16	25.50	2.25	19.00	4.75	16.19	0.50	20	1.38	1.25	22.50	250
18	28.00	2.38	21.00	5.12	18.20	0.50	24	1.38	1.25	24.75	295
20	30.50	2.50	23.12	5.50	20.25	0.50	24	1.38	1.25	27.00	370
24	36.00	2.75	27.62	6.00	24.25	0.50	24	1.62	1.50	32.00	550

\* Dimensions conform to ASTM A/SA-105; ANSI B16.5