

The Best Products, The Best Service...

SERVICE METAL

ONE CALL GETS IT ALL



Socket Weld Cap
6000# Forged Steel
Inches / Pounds

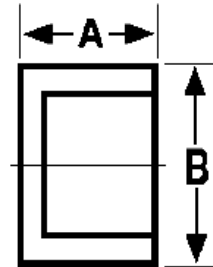

| Size | A | B | Approximate Weight (in Pounds) |
|-------|------|------|--------------------------------|
| 1/2 | 0.81 | 1.33 | 0.42 |
| 3/4 | 0.81 | 1.62 | 0.58 |
| 1 | 0.94 | 1.96 | 1.18 |
| 1 1/4 | 0.94 | 2.31 | 1.41 |
| 1 1/2 | 1.00 | 2.62 | 2.17 |
| 2 | 1.19 | 3.27 | 3.67 |

**ASTM SA-105, ANSI B16.11*